



INSTEON®

Siren  
Owner's Manual

## Contents

### Getting Started

Insteon Siren	4
Device Overview	4
Buttons	4
Installation	4
Protective Film	4
Alert Types	5

### Insteon app for iPhone, iPad and iPod touch

Add to the Insteon Hub	7
Configure Audible Alerts	8
Configure Arm and Disarm	10

### Insteon app for Android

Add to the Insteon Hub	13
Configure Audible Alerts	14
Configure Arm and Disarm	16

### Local Programming

About Local Programming	19
Local Programming Flow Chart	20

### Basic Linking

Triggering Siren from an Insteon Device	22
Arming and Disarming Siren from an Insteon Device	23

### Factory Reset

Factory Reset	26
---------------	----

### Appendix

Specifications	28
Troubleshooting	30
Certifications and Warnings	31
Product Warranty	32

## Getting Started

---



Everything you need to quickly get up and running.

## Insteon Siren

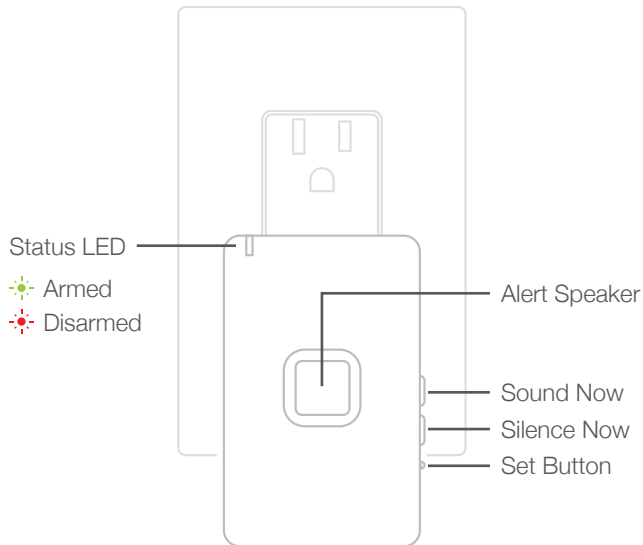
### Device Overview



### Buttons

-  **Sound Now**  
Tap to sound the currently selected alert tone.
-  **Silence Now**  
Tap to stop the currently playing alert tone.
-  **Set Button**  
Cycles through the available sound options and arm/disarm mode. Also used for basic linking and local programming.

### Installation

Plug Siren into an unswitched wall outlet.

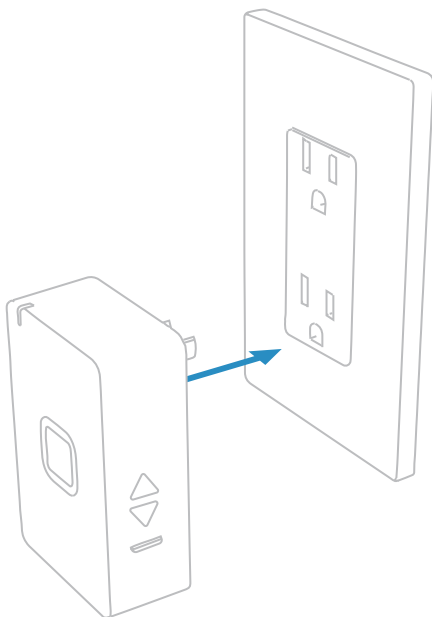

### Protective Film

Insteon Siren is loud. To reduce the siren volume, leave the protective film over the speaker in place.

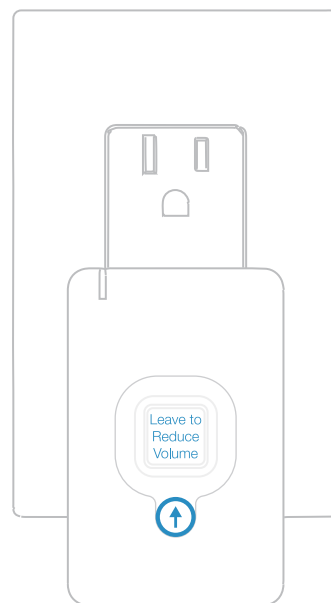

## Alert Types

Siren features two types of audible alerts. Choose the suitable alert when creating a Scene via Insteon for Hub app or tap-tap linking.



Siren

Loud ringing will sound if Siren is armed and triggered by a linked device. The loud ringing will persist for 2 minutes unless stopped by disarming Siren.



Chime

Two short beeps will sound if Siren is armed and triggered by a linked device.

### Caution



Siren is loud. Use hearing protection when testing in close proximity.

### **Insteon app for iPhone, iPad and iPod touch**

---

Use the Insteon app to configure and control Siren.

## Add to the Insteon Hub

iPhone, iPad and iPod touch

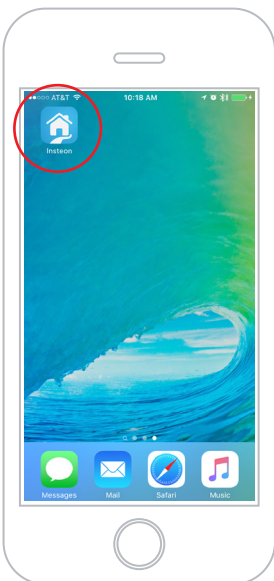

Launch the Insteon App

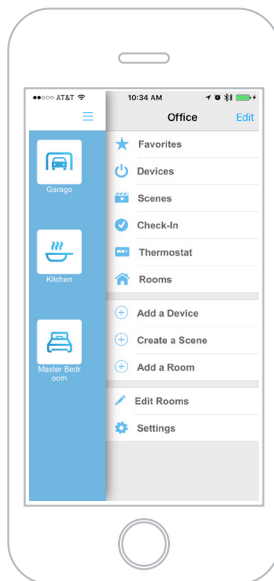

Tap the drawer icon or swipe from the right edge of the display to open the drawer

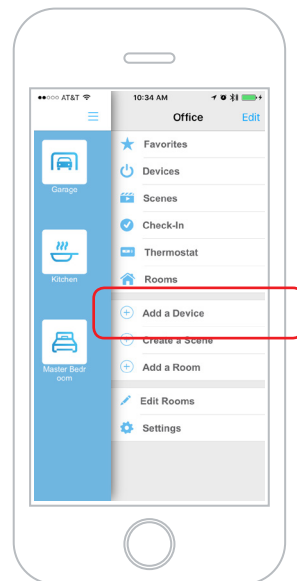

Tap Add a Device



Tap Plug-in Module

When prompted, press and hold the set button on Siren until the device double-beeps

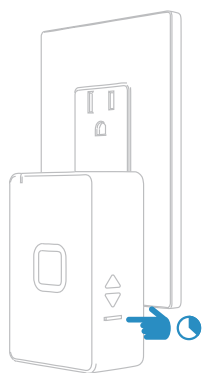

✓ You can now manage Siren with the Insteon app.

## Configure Audible Alerts

iPhone, iPad and iPod touch

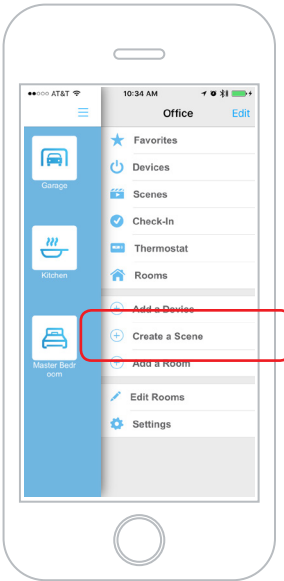

Open the Drawer and tap Create a Scene

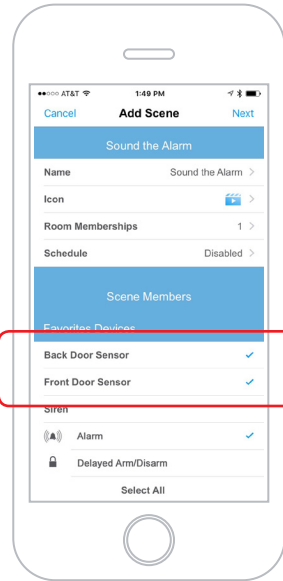

Select the devices that you would like to trigger Siren

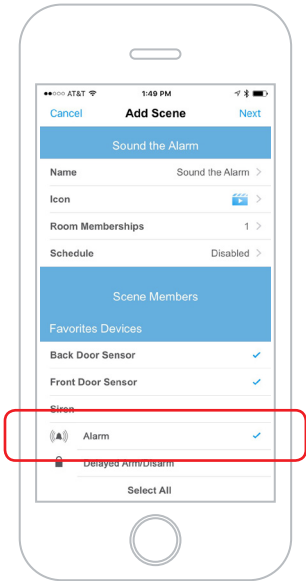

When selecting Siren, tap Alarm

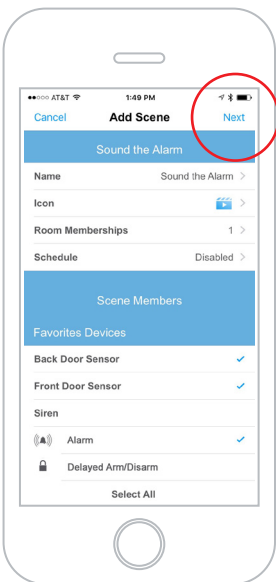

Tap Next

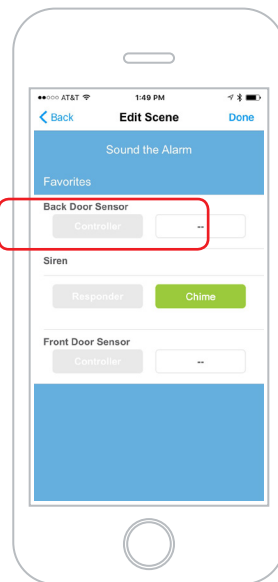

Ensure that all triggering devices are set as Controller by tapping the Controller, Responder, Both button until it reads Controller

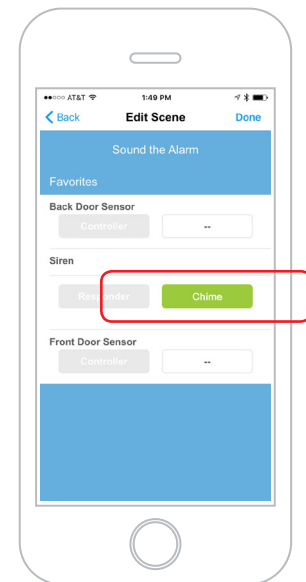

To choose the audible alert for Siren, tap the Chime/Siren button until the desired alert tone is displayed



## Configure Audible Alerts

iPhone, iPad and iPod touch

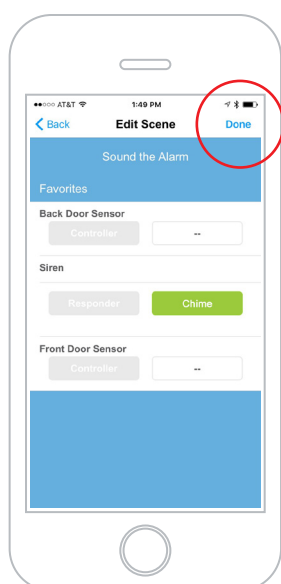

Tap Done to begin creating the scene

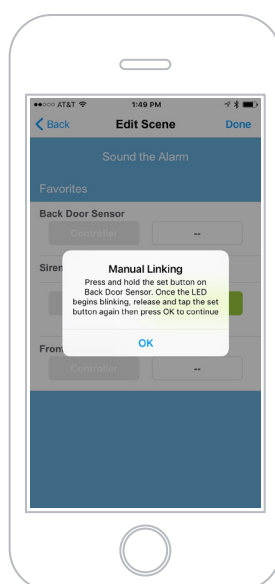

When prompted, press and hold the set button on any battery-powered sensors included in the Scene

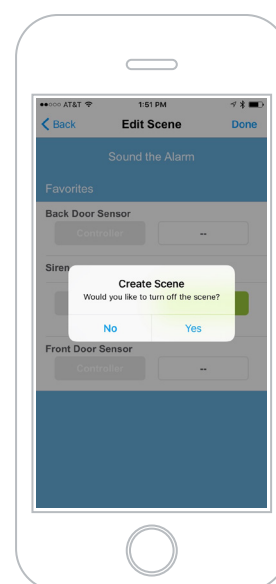

Tap Yes

✓ Your Siren is now configured for audible alerts.

## Configure Arm and Disarm

iPhone, iPad and iPod touch

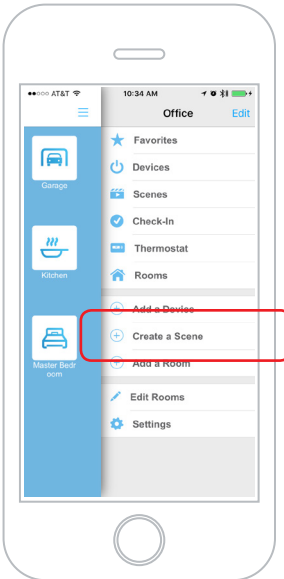

Open the Drawer and tap Create a Scene

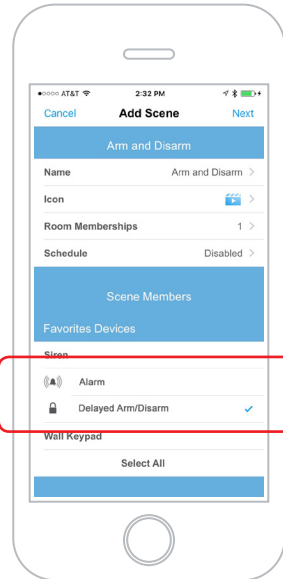

Select Siren and tap Delayed Arm/Disarm

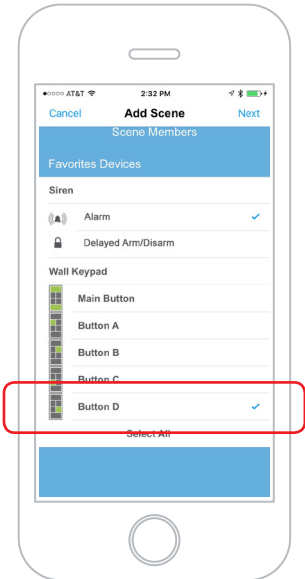

Select the devices that you would like to arm and disarm Siren

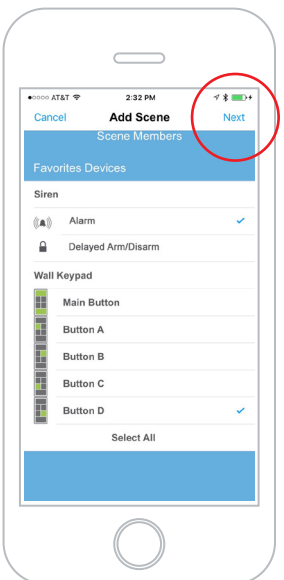

Tap Next

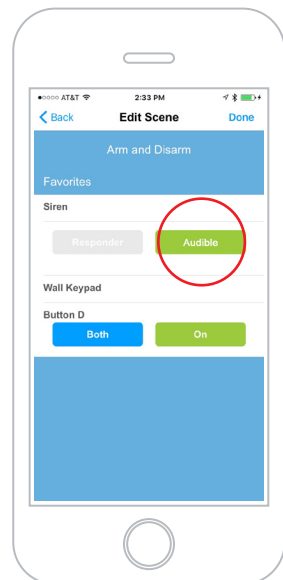

To choose between an audible or silent 45 second arming countdown tap Audible/Silent until the desired setting is displayed

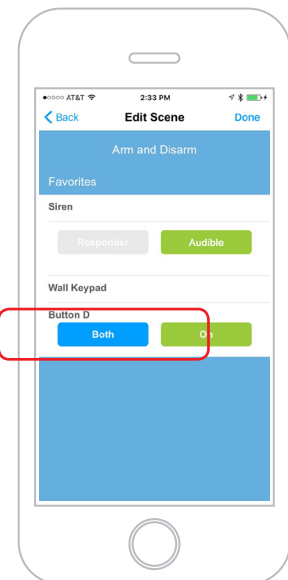

Ensure that all arming devices are set as Both by tapping the Controller, Responder, Both button until it reads Both

## Configure Arm and Disarm

iPhone, iPad and iPod touch

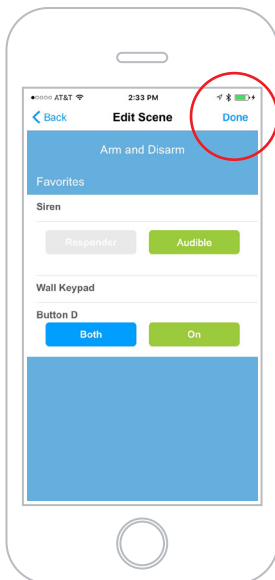

Tap Done to begin creating the scene

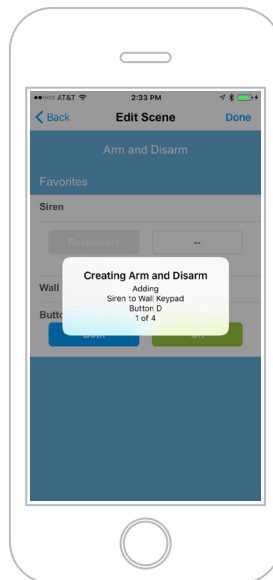

The Insteon app will create your Arm and Disarm scene

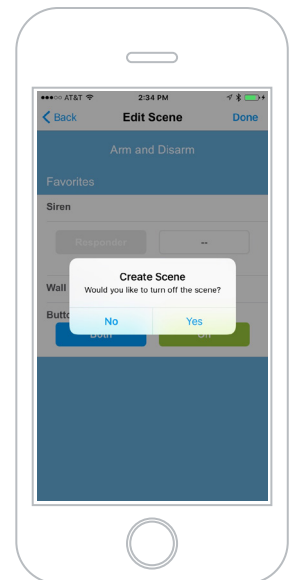

Tap Yes to complete the scene building process

✓ Your Insteon device will now arm and disarm Siren.

### **Insteon app for Android**

---

Use the Insteon app to configure and control Siren.

## Add to the Insteon Hub

Android

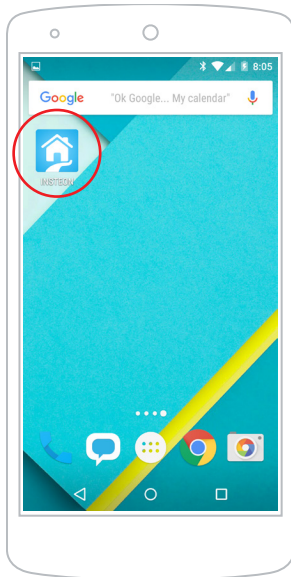

Launch the Insteon App

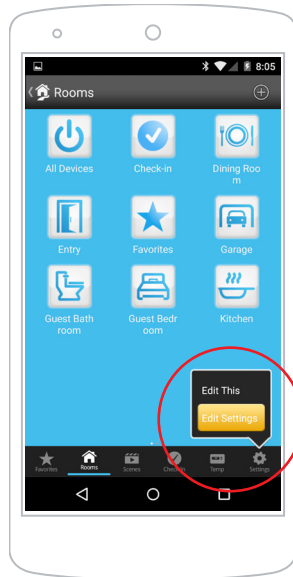

Navigate to Settings by tapping Edit Settings from the Settings button

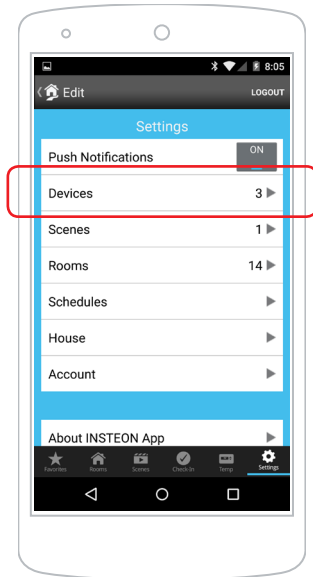

Tap Devices

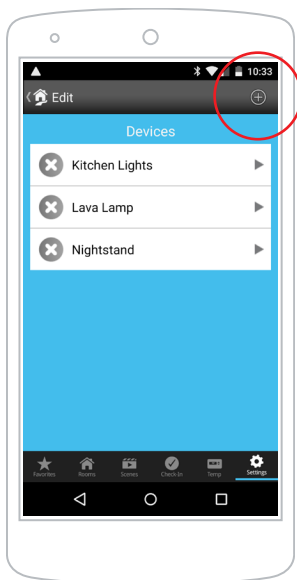

Tap the Add button

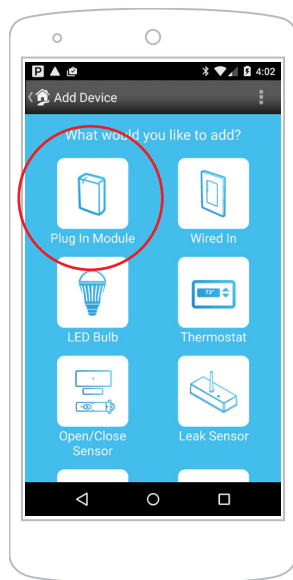

Tap Plug-In Module

When prompted, press and hold the set button on Siren until the device double-beeps

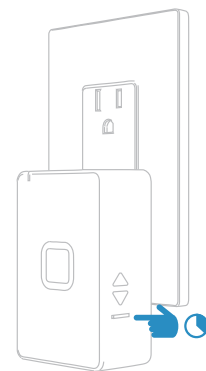

✓ You can now manage Siren with the Insteon app.

## Configure Audible Alerts

Android

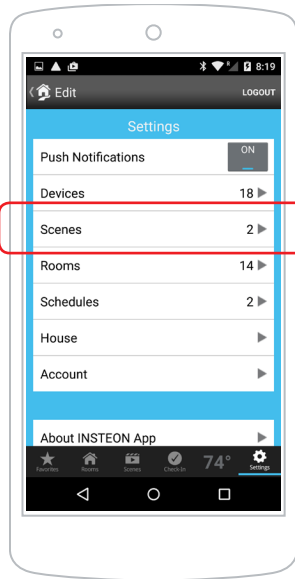

Navigate to Settings and tap Scenes

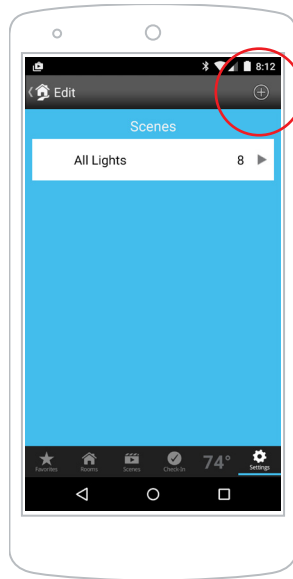

Tap Add to create a new Scene

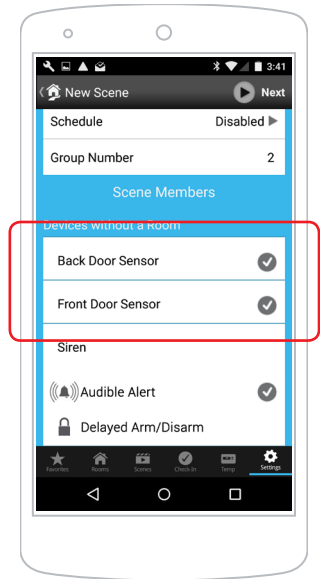

Select the devices that you would like to trigger Siren

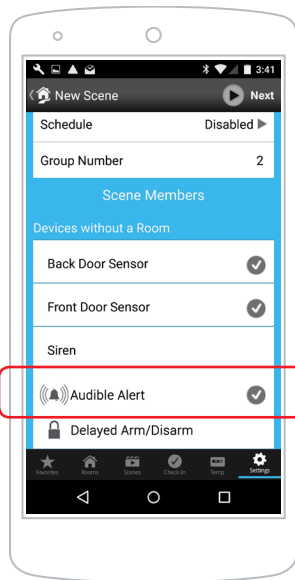

Select siren and tap Alarm; when ready, tap Next

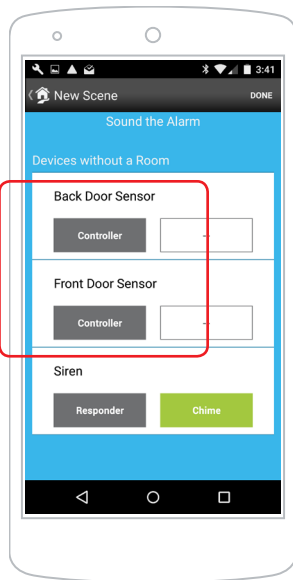

Ensure that all triggering devices are set as Controller by tapping the Controller, Responder, Both button until it reads Controller

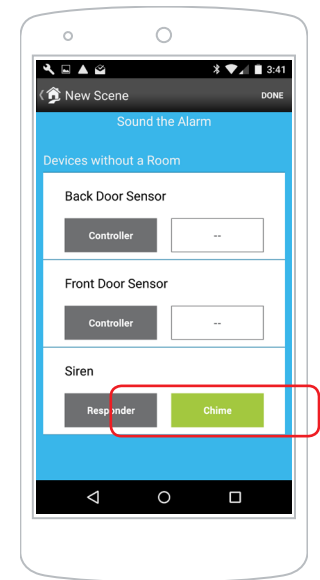

To choose the audible alert for Siren, tap the Chime/Siren button until the desired alert tone is displayed

## Configure Arm and Disarm

Android

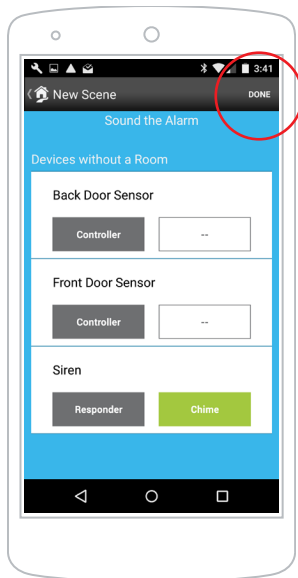

Tap Done to begin creating the scene

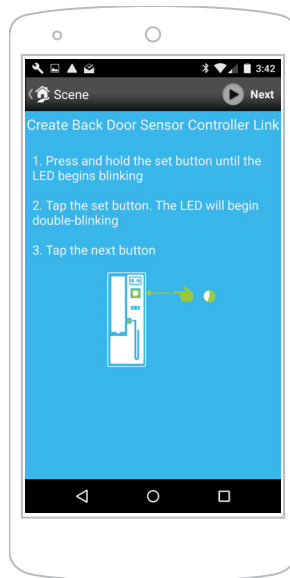

When prompted, press and hold the set button on any battery-powered sensors included in the scene

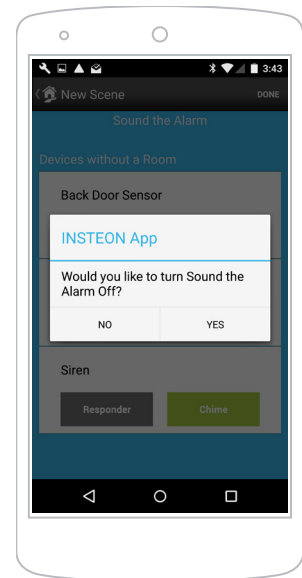

Tap Yes to complete the scene building process

✓ Your Siren is now configured for audible alerts.

## Configure Arm and Disarm Android

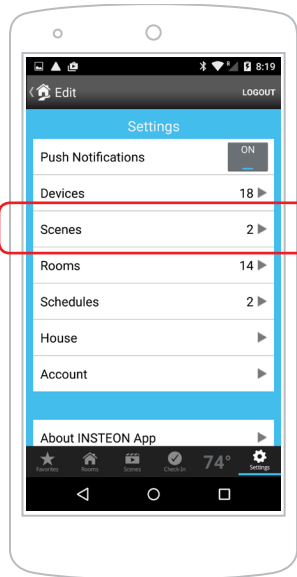

Navigate to Settings  
and tap Scenes

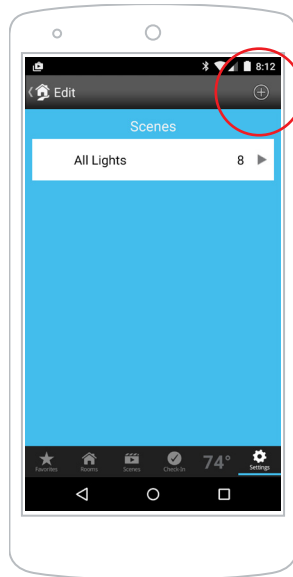

Tap Add to create a  
new Scene

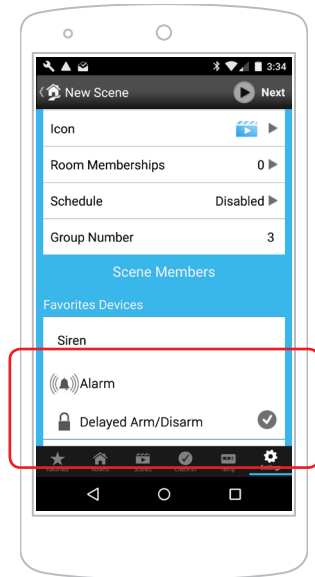

Select Siren and tap  
Delayed Arm and  
Disarm

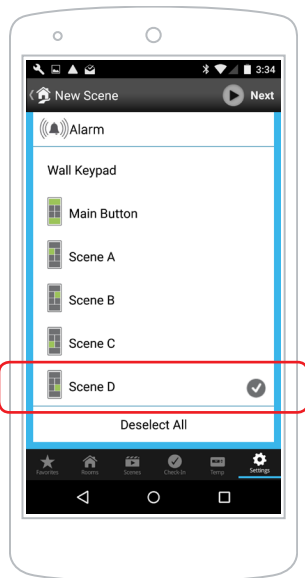

Select the devices that  
you would like to arm and  
disarm Siren

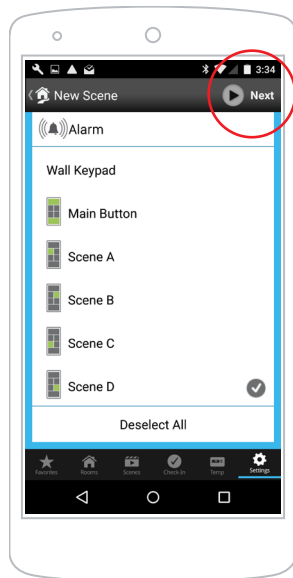

Tap Next

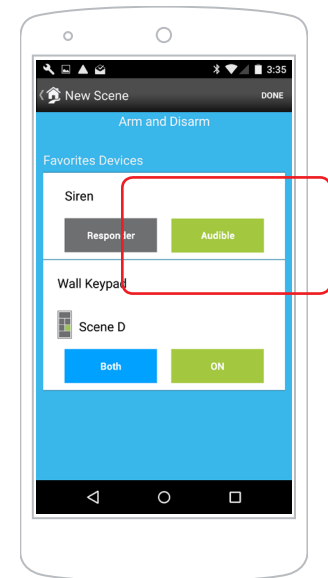

To choose between an audible  
or silent 45 second arming  
countdown tap Audible/Silent  
until the desired setting is  
displayed



## Configure Arm and Disarm

### Android

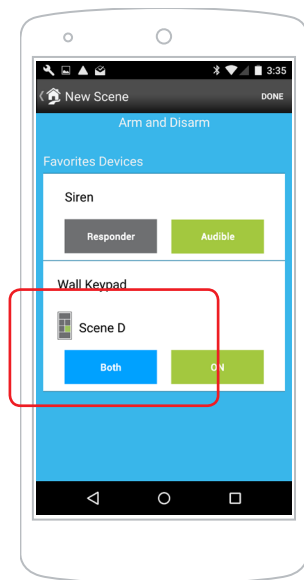

Ensure that all arming devices are set as Both by tapping the Controller, Responder, Both button until it reads Both

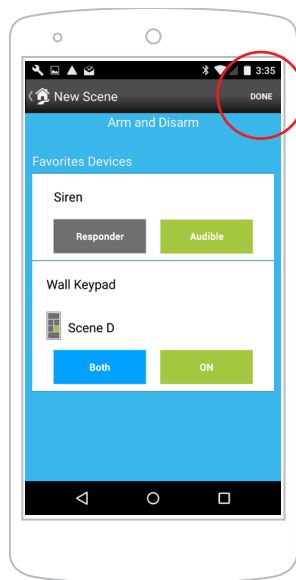

Tap Done to begin creating the scene

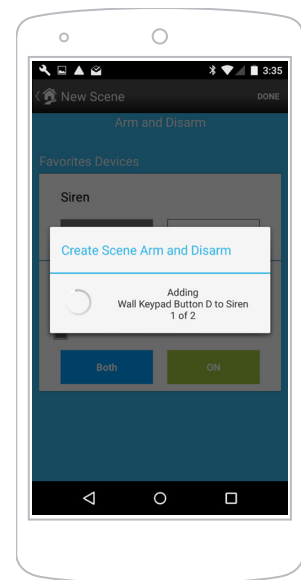

The Insteon app will create your Arm and Disarm scene

✓ Your Insteon device will now arm and disarm Siren.

## **Local Programming**

---

Use the local programming to link Insteon devices together with the set button.

## About Local Programming

### Local Programming

The Local Programming Flowchart is a visual representation of the device's settings. Many device features can be configured using this diagram. Some devices have more options than others but the Local Programming Flowchart presents even the most complicated devices with a straightforward, navigable path.

### Navigation



To move right, press and hold the set button



To move down, tap the set button

### Using a Central Controller

If using the Insteon Hub or any other central controller, it is strongly advised that you not use Local Programming. Your central controller can manage the device properties and links for you.



Status LED blinks green



Status LED double-blinks green



Status LED blinks red



Status LED double-blinks red

## Local Programming Features

Linking Mode	Readies the module for linking to another Insteon device. As linking is directional, the first device placed into linking mode will become the controller in the controller/responder relationship. The second device will become the responder. The device automatically exits linking mode after a link has been made with another Insteon device or four minutes have elapsed without linking.
Multi-Linking Mode	Readies the module for linking to multiple Insteon devices. The module will remain in linking mode for four minutes or until the module's set button is tapped. After each successful link, the four minute counter is reset. Use this mode to manually create a scene.
Unlinking Mode	Allows the removal of links from the Insteon device. The device will automatically exit unlinking mode after a link has been removed from another Insteon device or four minutes have elapsed without linking.
Multi-Unlinking Mode	Allows the removal of multiple links from the Insteon device. The device will stay in unlinking mode for four minutes or until the device's set button is tapped. After each successful unlink, the four minute counter is reset.

## Local Programming Flow Chart

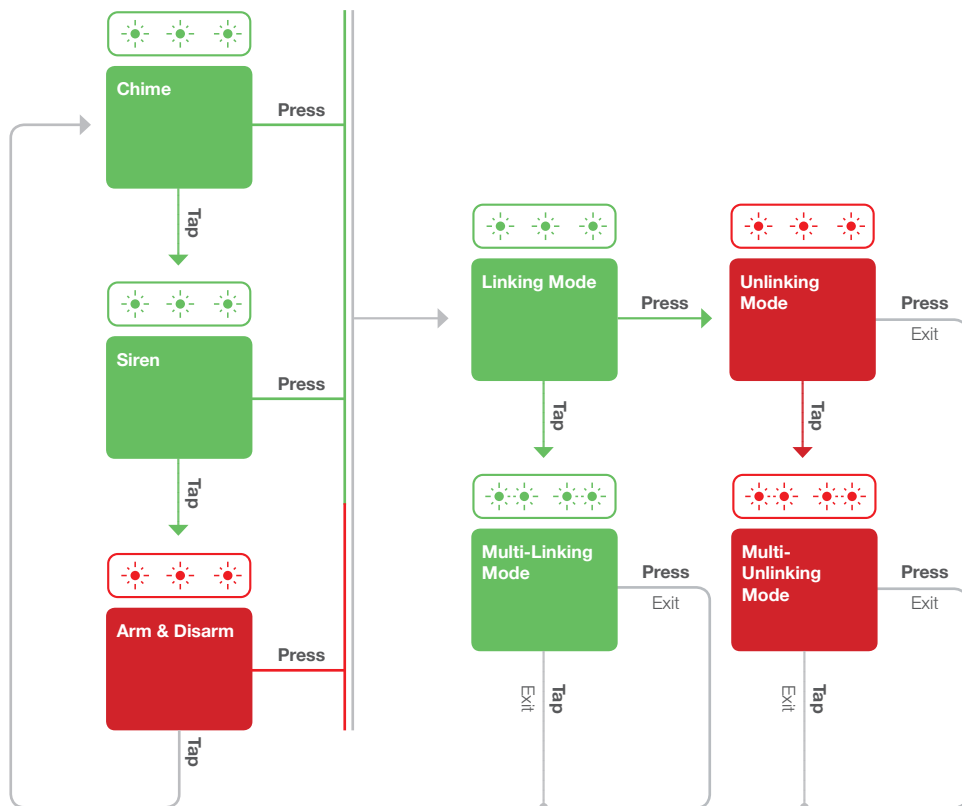

## **Basic Linking**

---

Configure Insteon Siren without Insteon Hub; do not use these instructions if you intend to use Siren with Insteon Hub or other Insteon management software.

## Triggering Siren from an Insteon Device

- 1 On the Insteon device that you would like to trigger Siren, press and hold the set button until its LED begins blinking.

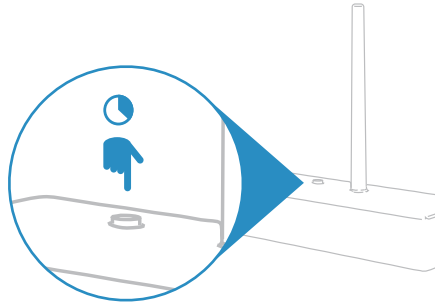

- 2 On Siren, tap the set button until you hear the desired alert tone.

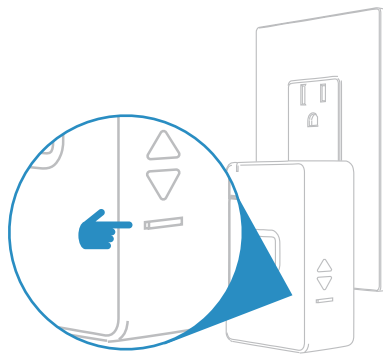

- 3 Press and hold the set button until you hear a double-beep.

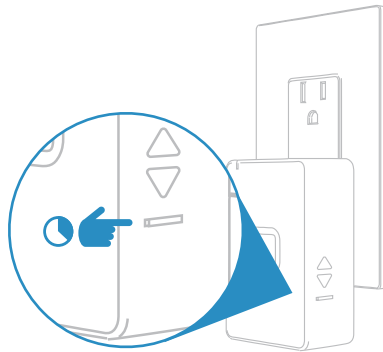

✓ Test Siren by triggering your sensor or turning on your Insteon device.  
**Caution: Siren is loud.**

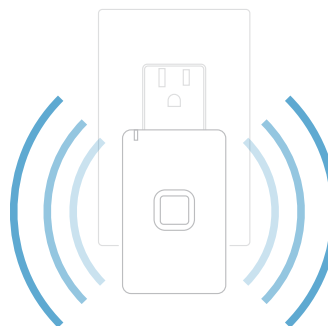

## Arming and Disarming Siren from an Insteon Device

You can use an Insteon device like a Wall Keypad or Mini Remote to arm and disarm Siren. When using a Wall Keypad, you can also see if Siren is armed or disarmed by looking at the arm and disarm button.

- 1 On the Insteon device that you would like to use to arm and disarm Siren, tap the desired button.

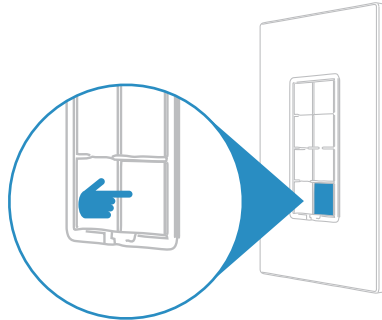

- 2 Press and hold the set button until the device's LED begins blinking.

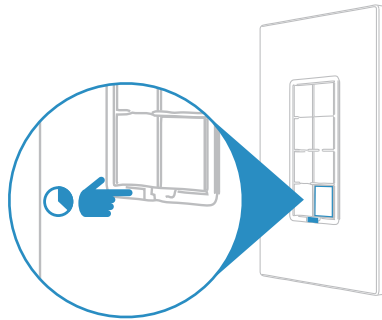

- 3 On Siren, tap the set button until the status LED glows red.

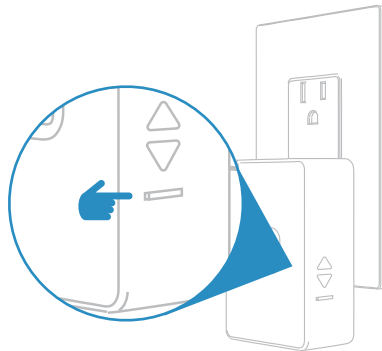

- 4 Press and hold the set button until you hear a double-beep.

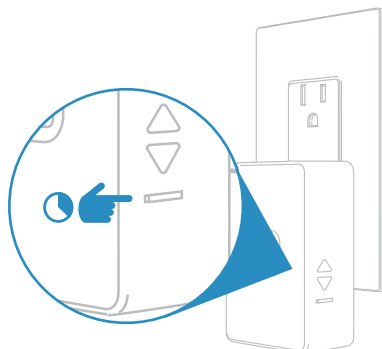

## Arming and Disarming Siren from an Insteon Device

5

Test Siren by arming from your Insteon device. While arming, Siren will beep for 45 seconds and any linked devices will not trigger the siren or chime.

To cancel arming, tap the button again (or turn controller off).

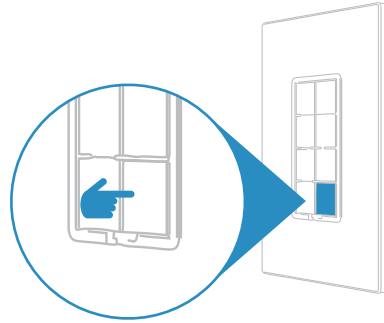

Your Insteon device will now arm and disarm Siren

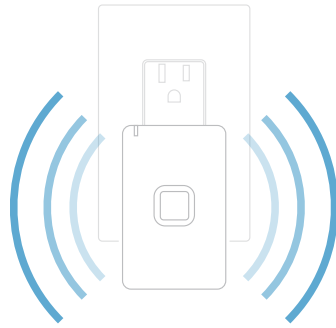



## **Factory Reset**

---

A factory reset will erase all links stored in the device's database as well as any customized properties.

## Factory Reset

- 1 Unplug Siren from its power outlet

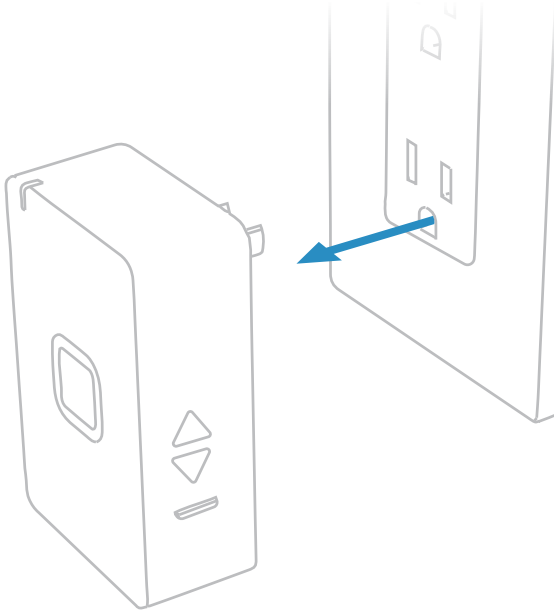

- 2 Simultaneously press and hold the set button while reconnecting Siren to power

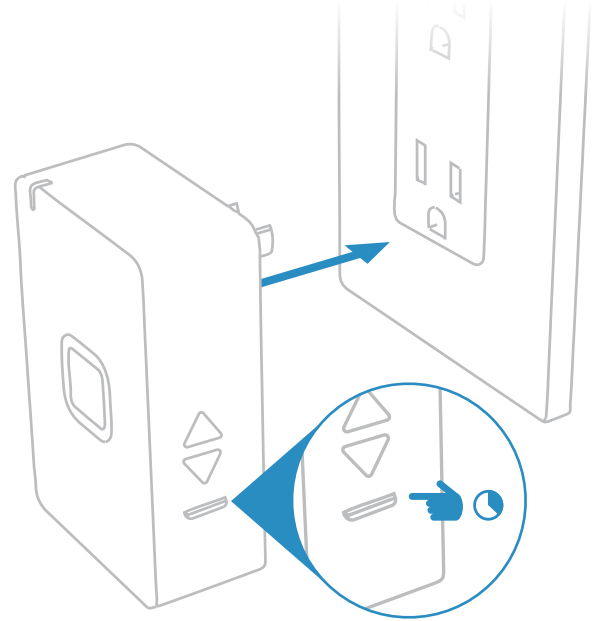

- 3 Continue holding the set button until Siren stops beeping

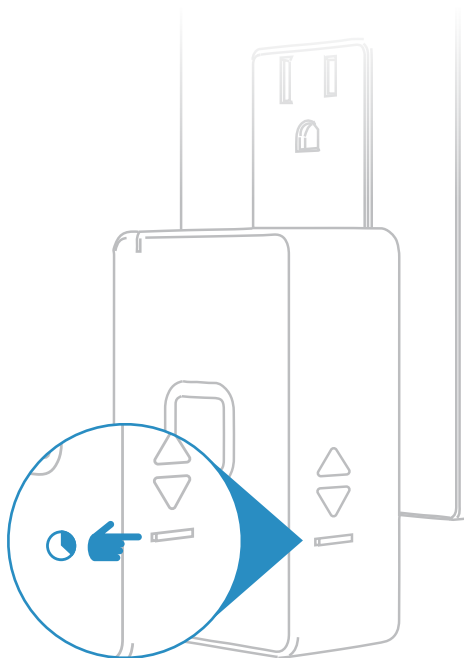

- 4 When the reset is complete, Siren will double-beep

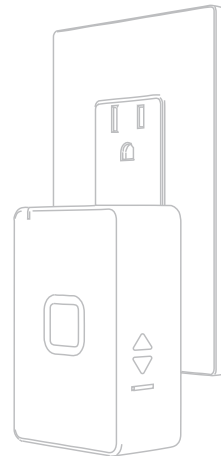

✓ Your Siren has been restored to factory settings.

## **Appendix**

---

Everything else you might need to know about your Insteon product.

## Specifications

### General

Available Colors	White
Brand:	Insteon
FCC ID	SBP2457D2A
Industry Canada	5202A-2457D2A
Manufacturer Product No.:	2868-222
Patent No.:	Protected under US and Foreign Patents (see <a href="http://www.insteon.com/patents">www.insteon.com/patents</a> )
UPC:	813922015713
Warranty:	2 years, limited

### Operation

Audio Alert	Beeper, Chime, Siren
Chime Volume	100 dB at 1 meter
Siren Volume	115 dB at 1 meter
Setup Memory	Non-volatile EEPROM
Status LED	Red/Green LED

### Insteon Features

Insteon Device Category	0x07
Insteon Device Subcategory	0x1E
Insteon Links	24
Insteon Messages Repeated	Yes
Insteon Minimum Receive Level	10 mV
Insteon Minimum Transmit Level	3.2 Vpp into 5 Ohms
Insteon Powerline Device	Yes
Insteon Powerline Frequency	131.65 KHz
Insteon RF Device	Yes
Multi-Link Support	Yes
Multi-Unlink Support	Yes
RF Beacon	Yes

Radio Frequency	915.0 MHz	
Radio Frequency Range	150 feet	
Scene Commands Supported as Controller	Fast-On	Fast-Off
Scene Commands Supported as Responder	On, Fast-On	Off
Software Configurable	Yes	

## Mechanical

Dimensions	3.2" H x 2.05" W x 1.05" D 81.2mm H x 53mm W x 26.6mm D	
Enclosure Material	UV stabilized plastic	
Mounting	Ungrounded, polarized electrical outlet, NEMA 1-15	
Operating Environment	Indoors	
Operating Humidity Range	0-85% relative humidity, non-condensing	
Operating Temperature Range	32° to 104° F 0° to 40° C	
Set Button	Yes	
Storage Temperature Range	-4° to 158° F -20° to 70° C	
Weight	3.3 oz	

## Electrical

Power Consumption	<0.75 Watts	
Supply Voltage	120 Volts AC $\pm$ 10%, 60 Hertz, single phase	
Surge Resistance	Surges over 1,000 volts	



### **Troubleshooting**

For detailed troubleshooting information,  
visit [insteon.com/get-started-2868-222](https://www.insteon.com/get-started-2868-222)

## Certifications and Warnings

Read and understand these instructions before installing and retain them for future reference.

This product is not designed or approved for use on powerlines other than 120VAC, 60Hz, single phase. Attempting to use this product on unapproved powerlines may have hazardous consequences.

- Use only indoors or in outdoor rated box
- This product may feel warm during operation. The amount of heat generated is within approved limits and poses no hazards. To minimize heat buildup, ensure the area surrounding this product is as clear of clutter as possible.
- Each Insteon product is assigned a unique Insteon ID, which is printed on the product's label.

This device complies with FCC Rules and Industry Canada license-exempt RSS standard(s). Operation is subject to the following two conditions: (1) this device may not cause harmful interference, and (2) this device must accept any interference, including interference that may cause undesired operation of the device.

Le présent appareil est conforme aux CNR d'Industrie Canada applicables aux appareils radio exempts de licence. L'exploitation est autorisée aux deux conditions suivantes: (1) l'appareil ne doit pas produire de brouillage, et (2) l'utilisateur de l'appareil doit accepter tout brouillage radioélectrique subi, même si le brouillage est susceptible d'en compromettre le fonctionnement.

## Product Warranty

### Limited Warranty

Seller warrants to the original consumer purchaser of this product that, for a period of two years from the date of purchase, this product will be free from defects in material and workmanship and will perform in substantial conformity to the description of the product in this Owner's Manual. This warranty shall not apply to defects or errors caused by misuse or neglect. If the product is found to be defective in material or workmanship, or if the product does not perform as warranted above during the warranty period, Seller will either repair it, replace it, or refund the purchase price, at its option, upon receipt of the product at the address below, postage prepaid, with proof of the date of purchase and an explanation of the defect or error. The repair, replacement, or refund that is provided for above shall be the full extent of Seller's liability with respect to this product. For repair or replacement during the warranty period, call 866-243-8022 with the Model # and Revision # of the device to receive an RMA# and send the product, along with all other required materials to:

Insteon  
ATTN: Receiving  
16542 Millikan Ave.  
Irvine, CA 92606-5027

### Limitations

The above warranty is in lieu of and Seller disclaims all other warranties, whether oral or written, express or implied, including any warranty or merchantability or fitness for a particular purpose. Any implied warranty, including any warranty of merchantability or fitness for a particular purpose, which may not be disclaimed or supplanted as provided above shall be limited to the two-year of the express warranty above. No other representation or claim of any nature by any person shall be binding upon Seller or modify the terms of the above warranty and disclaimer.

Home automation devices have the risk of failure to operate, incorrect operation, or electrical or mechanical tampering. For optimal use, manually verify the device state. Any home automation device should be viewed as a convenience, but not as a sole method for controlling your home.

In no event shall Seller be liable for special, incidental, consequential, or other damages resulting from possession or use of this device, including without limitation damage to property and, to the extent permitted by law, personal injury, even if Seller knew or should have known of the possibility of such damages. Some states do not allow limitations on how long an implied warranty lasts and/or the exclusion or limitation of damages, in which case the above limitations and/or exclusions may not apply to you. You may also have other legal rights that may vary from state to state.