

I N S T E O N<sup>®</sup>



**INSTEON Wireless Switch**  
Quick Start Guide

# INSTEON Wireless Switch



Sent On

Sent Off

Status LED

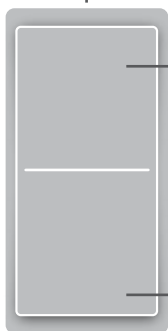

On

Off



Charging Port  
(Micro USB)

Set Button

On/Off Switch



On



Off

## Charging

Fully charge your Wireless Switch before use. Your Wireless Switch battery lasts 9-12 months between charges with average use.

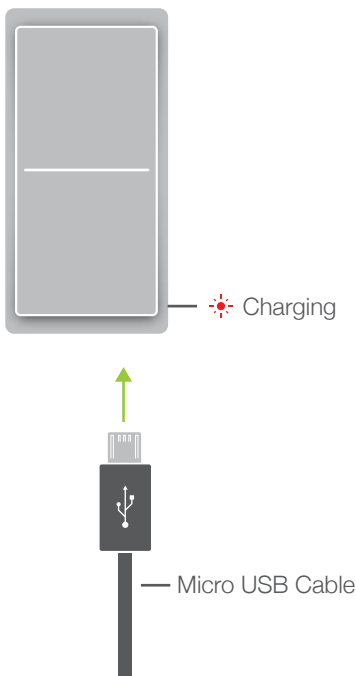

## Mounting

You can place your Wireless Switch in-line with existing switches using the Wall Mount Kit (Sold Separately).

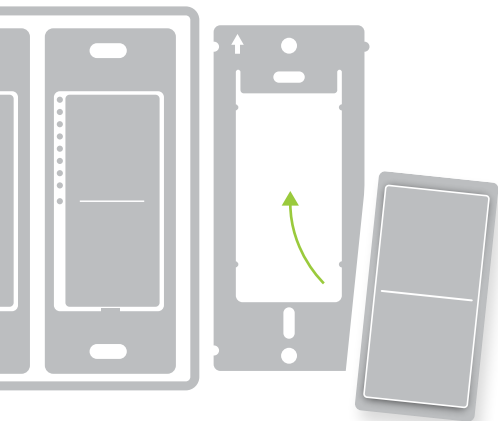

Do not mount Wireless Switch **over** an open junction box.

## Linking

- 1 Tap the top of the switch and then press and hold the set button until the Wireless Switch beeps.

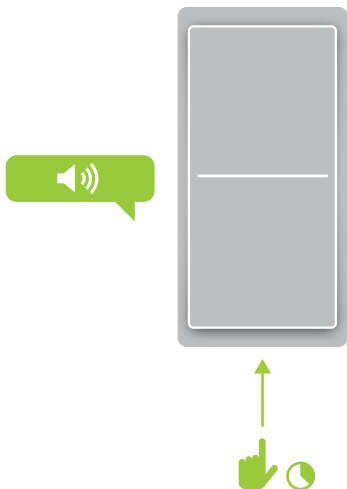

2

Make sure the device you wish to control is ON and then press and hold its set button until it double-beeps.

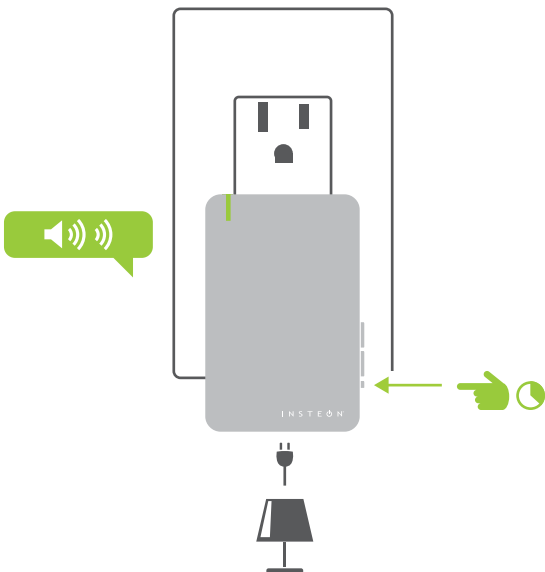

3

Your Wireless Switch will now control your INSTEON device.

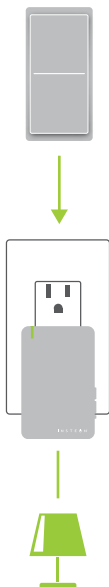

## Learn More

For the complete Owner's Manual, video tutorials, product support and more, visit:  
**[insteon.com/support](http://insteon.com/support)**.

