

Status LED
 Linking
 Unlinking
 Idle

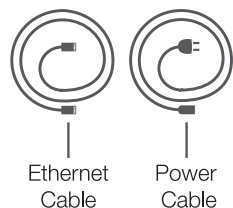

1 Setup

Connect your Hub to your router and a power outlet using the cables provided. Avoid switched outlets or power strips. Wait 2 minutes for the Hub to start up.

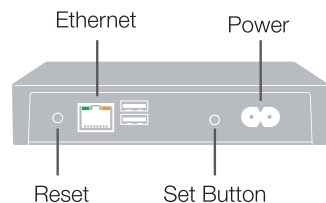
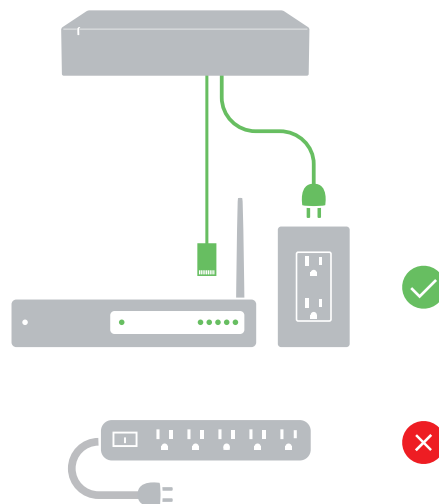

Ensure that your mobile device WiFi is turned on and connected to your network.



Support and Resources

For a list of how-tos and troubleshooting guides, visit insteon.com/hub-homekit-setup

2 Add Insteon Hub

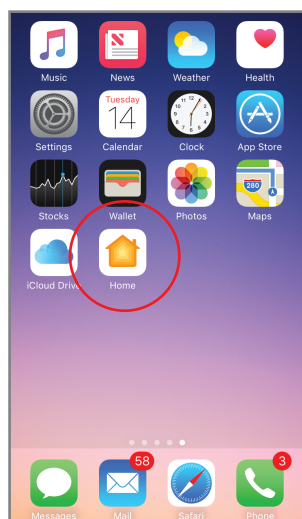

Launch the Apple Home app on your iOS device

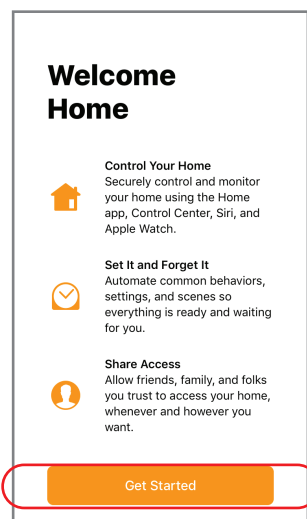

Tap Get Started

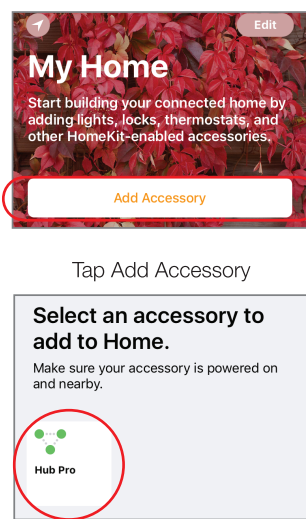

Tap Hub Pro

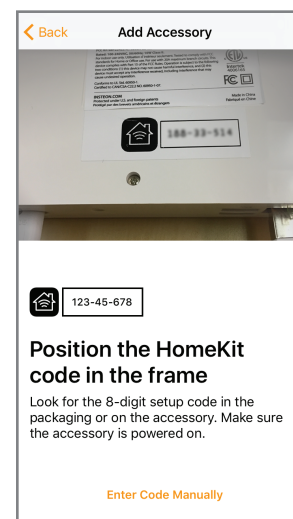

Scan the Accessory Setup Code found on the bottom of the Hub or on the included info card. You may also enter the code manually.

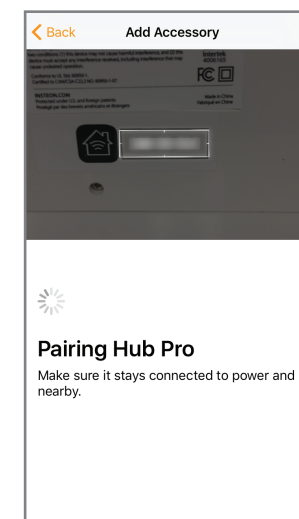

Once the code is recognized, wait while the Hub is added to HomeKit.

[instructions continued on other side]

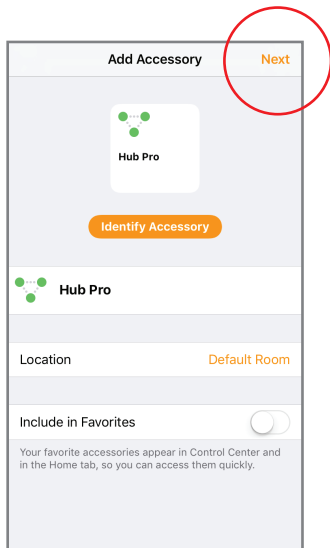

Tap Next.

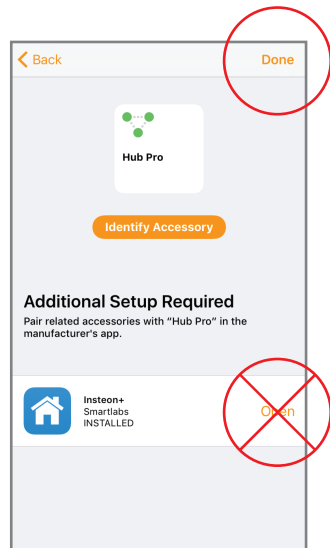

Tap Done. Do not use the Insteon+ app for additional setup.

3 Add Insteon Devices

A



Press and hold the set button located on the back of the Hub Pro until you hear a beep. The Status LED on the front will begin blinking green.

B

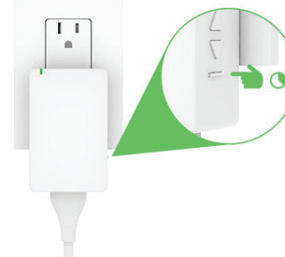

Press and hold the set button on your Insteon device until it double beeps or you hear a beep from the Hub Pro. If adding Insteon bulbs, remove power and re-apply power. Bulbs will enter linking mode on power up.

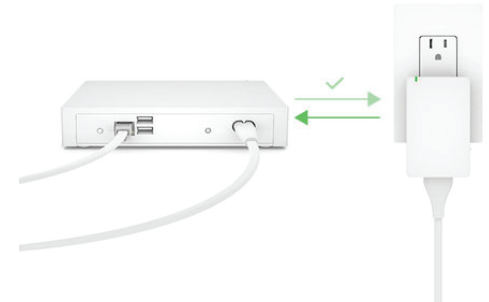

Repeat steps A and B in reverse order starting with the Insteon device. This is only necessary for Insteon devices that can be controlled locally (such as wall switches).

Repeat these steps for each device you want to control. When finished return to the Home app.



Trouble Adding Devices?

If you're having difficulty adding Insteon devices, see our support articles on insteon.com.

insteon.com/hub-homekit-setup

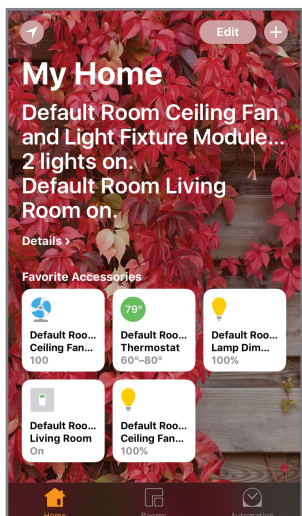

After adding your Insteon devices, return to the Home app and you will see the devices

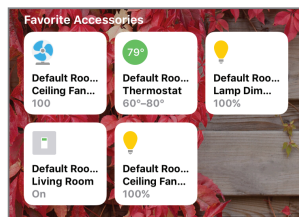

Tapping a device in the Home app will toggle between turning the device on and off. Press and holding will display a full control panel which is necessary for controlling things like setting a dim level or adjusting a thermostat.



Learn more?

Learn more about the Apple Home app:

<https://support.apple.com/en-us/HT204893>



Remote Access & Automations

To control your accessories remotely, you need one of the following devices:

Apple TV (3rd Generation)*
Apple TV (4th generation) with tvOS 9.0 or later

To set up automations and user permissions, you need one of the following devices:

Apple TV (4th generation) with tvOS 10
iPad with iOS 10

*Apple TV (3rd generation) doesn't support remote access to HomeKit-enabled cameras.

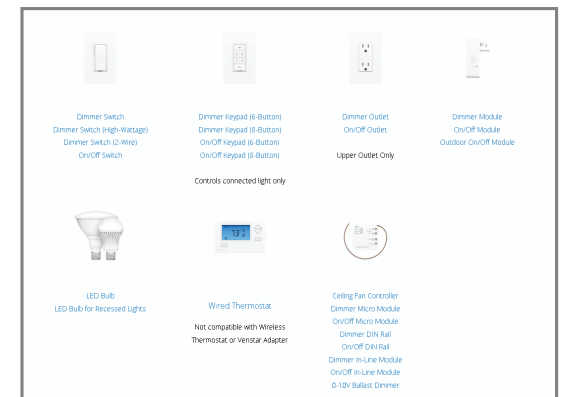

Compatible Insteon Devices

To see all the devices that are compatible with Insteon Hub Pro and the Apple Home app, visit:

www.insteon.com/homekit