

I N S T E  N<sup>®</sup>

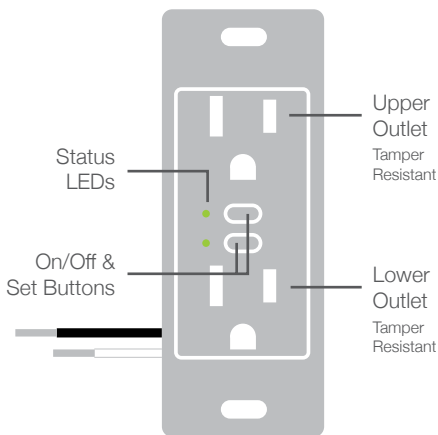

**INSTEON On/Off Dual-Outlet**  
Quick Start Guide

# INSTEON On/Off Dual-Outlet



For the complete Owner's Manual and more, visit: **[insteon.com/support](http://insteon.com/support)**

## Tools Needed for Installation



Phillips Screwdriver



Flathead Screwdriver



Voltage Detector



Wire Cutter / Stripper



### Disconnect Power

Always disconnect power before installation. Contact INSTEON Support when uncertain about installation.

**1-866-243-8022**

## Basic Installation

- 1 Turn off power to your outlet at the electrical service panel.



Circuit Breakers

or

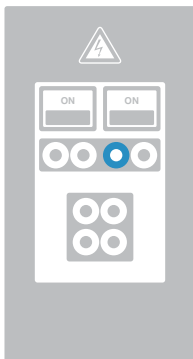

Fuse Panel



Power is ON



Power is OFF

2

Remove the old outlet and disconnect the wires. Be sure there is about  $\frac{1}{2}$  inch of bare wire showing.

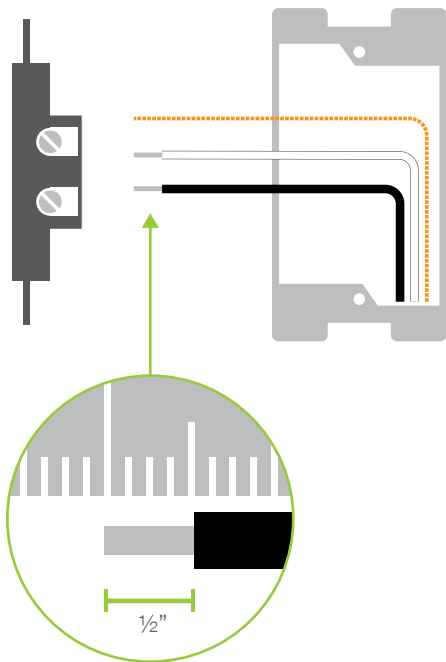

3

Turn on power at the circuit breaker and use a voltage detector to carefully identify **line** and **neutral**. **Line** will be energized.

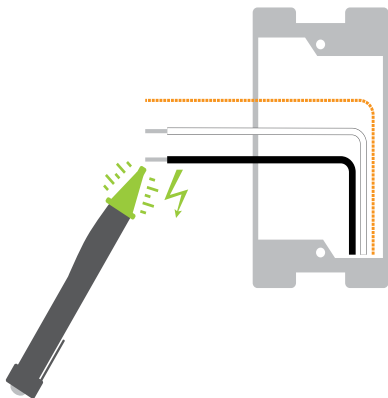

4

Turn off power at the circuit breaker. Connect junction box. Verify that the wire nuts are secure except for the bare ground wire.

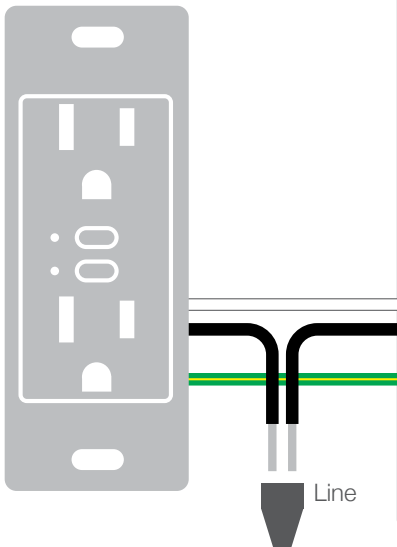

the Outlet wires to the identified wires in the  
are and that no exposed copper wire is visible

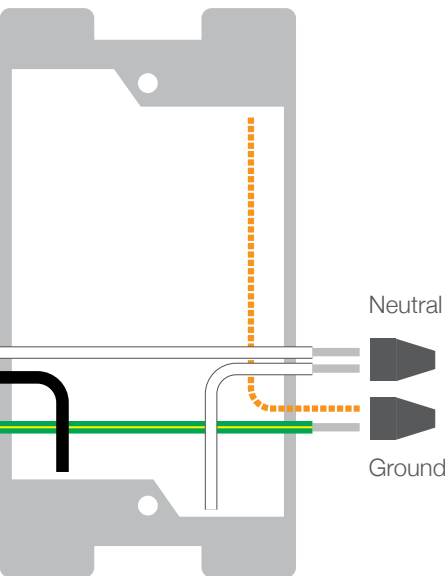



5

Mount the Outlet into the junction box and turn power on to the outlet at the circuit breaker panel.

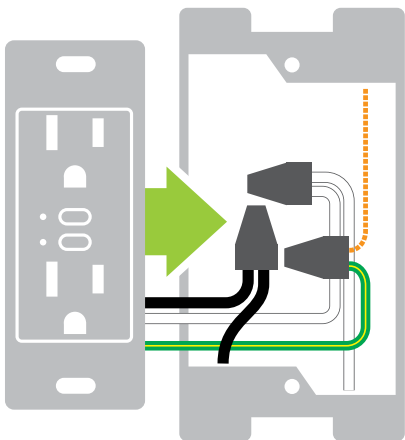

6

Ensure your appliance is on and test your On/Off Outlet by tapping one of the two set buttons. Your appliance will turn on and off.

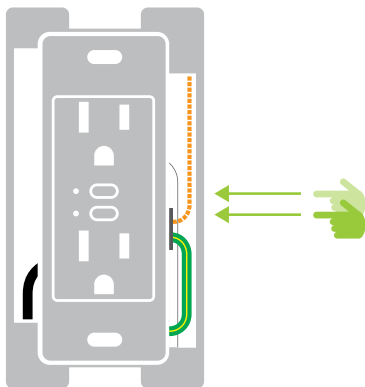

Installation complete. You can now add your On/Off Dual-Outlet to the Hub.

## Linking to the Hub

Follow the on-screen instructions to add your On/Off Dual-Outlet to the INSTEON Hub.



When prompted, press and hold one of the set buttons on the On/Off Dual-Outlet.

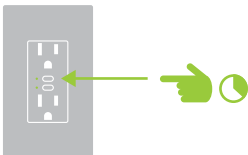

If not using the Hub, refer to the instructions that came with your product.

## Device Control

Turn on, turn off, set schedules and create scenes for your On/Off Dual-Outlet using the INSTEON Hub and App.

