

I N S T E E N[®]

Getting Started with Insteon LED Bulb for Recessed Lights

For more documentation, visit:
[insteon.com/get-started-2674-222](https://www.insteon.com/get-started-2674-222)



Do not connect LED Bulb to dimmers. Instead, link LED Bulb with Insteon remotes and switches to dim.



After installation, leave your lamp on. If you turn off your lamp, you won't be able to control LED Bulb.

- 1 Turn off your light fixture and install LED Bulb.

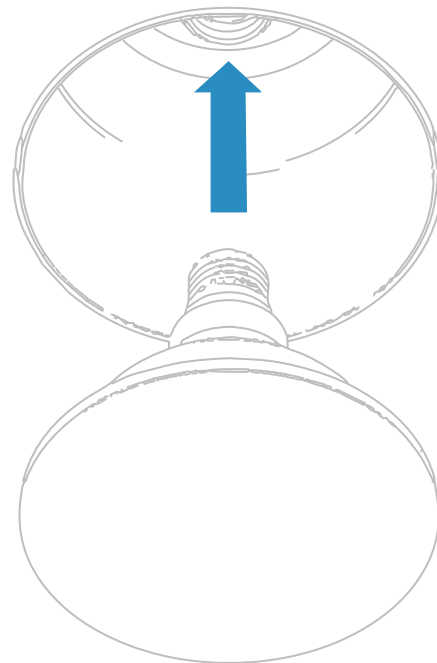

2

Follow the on-screen instructions in the Insteon app to add LED Bulb.



The Insteon app requires Insteon Hub.
Learn more at: insteon.com/hub

3

When prompted, turn on your light fixture.

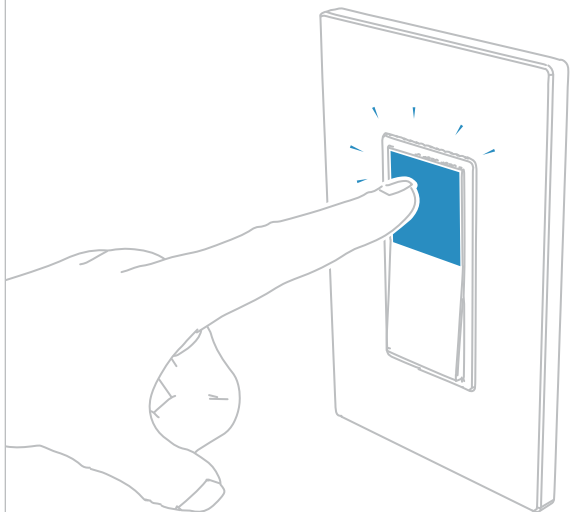

Go further and create schedules to turn your devices on and off at specific times.

insteon.com/schedules



Go further and control multiple devices simultaneously with scenes.

insteon.com/scenes