

I N S T E  N

Getting Started with Insteon On/Off Module

For more documentation, visit:
insteon.com/get-started-2635-222

- 1 Turn on your lamp or appliance and connect it's power cord to On/Off Module.

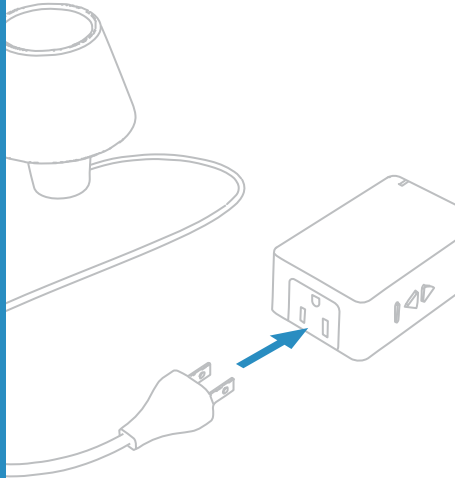

- 2 Plug On/Off Module into a power outlet.

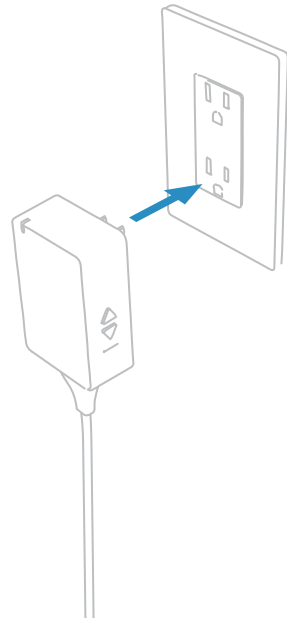

3

Follow the on-screen instructions in the Insteon app to add On/Off Module.



The Insteon app requires Insteon Hub.
Learn more at: insteon.com/hub

4

When prompted, press and hold the set button until On/Off Module beeps.

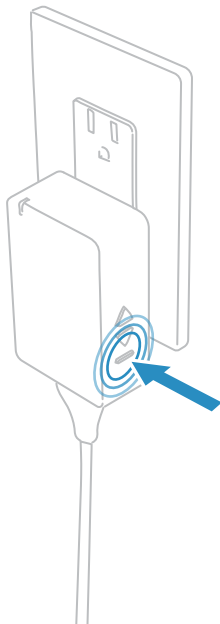

Go further and create schedules to turn your devices on and off at specific times.

insteon.com/schedules



Go further and control multiple devices simultaneously with scenes.

insteon.com/scenes