

## Getting Started with Insteon Micro Module

- ① **Turn off power** at the service panel and remove the existing wall switch.

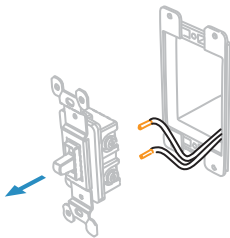

- ② Unfold all of the wires from within the junction box. Separate the black wires and cap them with wire nuts.

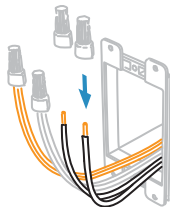

- ③ **Turn on power** and use a voltage detector to identify the live wire; this is your line wire.

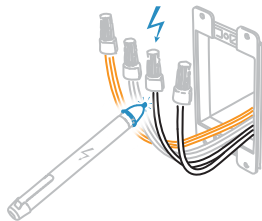

- ④ **Turn off power** and connect the corresponding wires. Refer to the reverse side for sense wire wiring.

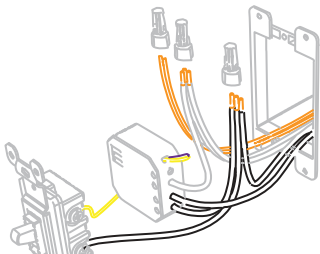

- ⑤ Reinstall your wall switch, attach the wall plate and **turn on power**.

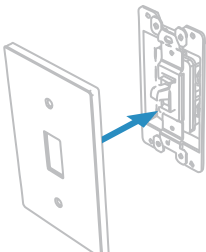

- ⑥ Follow the on-screen instructions in the Insteon app to add Micro Module.



This is your device's Insteon ID; use it when adding Micro Module to the Insteon app.

For more documentation, visit:  
[insteon.com/get-started-2442-222](http://insteon.com/get-started-2442-222)

## Dimmer Micro Module Wiring Guide



Learn how to configure switching sense modes between latching, single- and dual-momentary.

[insteon.com/sensewires](http://insteon.com/sensewires)

When using **without a switch**, cap the two sense wires.

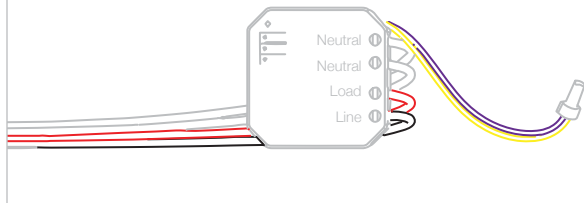

When using with a **latching or single-momentary switch**, connect line and the yellow sense wire to your switch.

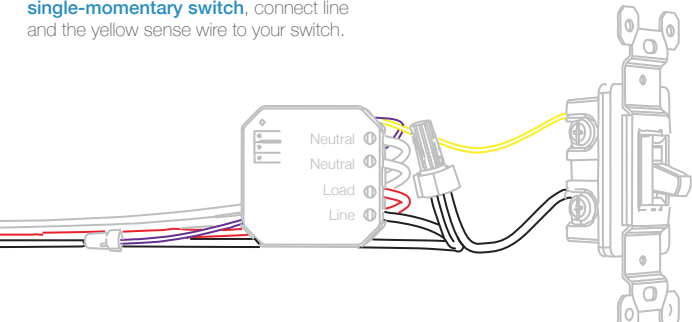

When using a **dual-momentary switch**, connect line and both the yellow and purple sense wires to your switch.

